

Bellsouth FastAccess Wireless HomeNetworking Fast Start Guide

Bellsouth® FastAccess®
Internet Service

Welcome to BellSouth FastAccess Wireless HomeNetworking Service.

This Fast Start Guide is intended to give you a high level overview of the key steps required to install your FastAccess Wireless HomeNetworking Service. For more detailed information, please refer to the FastAccess Wireless HomeNetworking Installation Guide.

Do Not Skip Steps

It is very important for you to follow these step-by-step instructions in order.



Step 1

Getting Started

You will need to complete the following steps before starting your FastAccess HomeNetworking installation:

Please note that you will need the username (primary email address) and password that you selected when you ordered FastAccess DSL Service. For example, your username is: username@bellsouth.net.

- Review your HomeNetworking design that was created during your ordering process. It is very important that you connect your network as recommended. Go to www.fastaccessnetworking.com to retrieve a copy of your HomeNetworking design.
- Be sure to back up any important files on your hard drive before beginning your installation.
- Disable the "Auto Start" function on all personal firewalls, VPN clients, anti-virus and proxy software. Consult their help files for specific instruction. These programs may cause a conflict during the install process. After the installation is completed reinstall all programs.

Windows 95 Users: The FastAccess HomeNetworking installation process does not support Windows 95. You must upgrade your operating system prior to installation.

Windows 98 or 98 Second Edition Users: There are two editions of the Windows 98 Operating System. To install FastAccess Wireless HomeNetworking Service you must verify which edition of Windows 98 you have. Windows 98 Second Edition supports all connections (USB, Ethernet and PCI). Windows 98 does not support USB connections.

Step 2

Install Your Filters

Every phone jack on your DSL line with a telephone or phone equipment such as answering machines, fax machines, caller ID unit, etc. attached must have filters installed.

- **Line filter:** Install on all desktop phones and telephone devices.

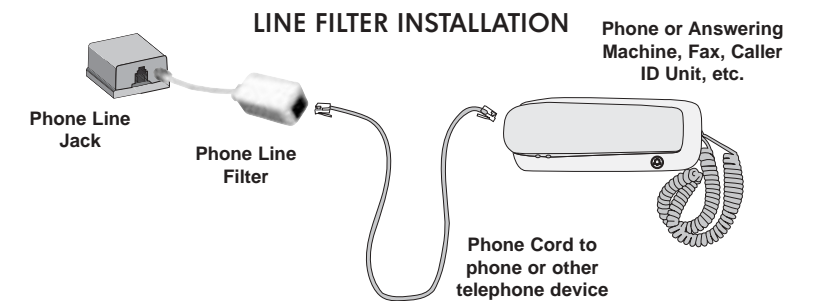

- **Wall filter:** Install the filter to the wall phone jack as shown.

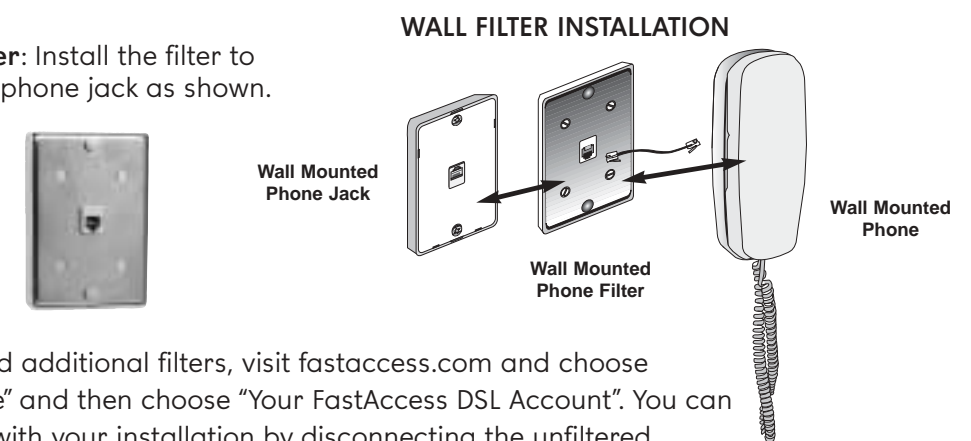

If you need additional filters, visit fastaccess.com and choose "For Home" and then choose "Your FastAccess DSL Account". You can continue with your installation by disconnecting the unfiltered telephone equipment until you receive your additional filter.

Step 3

Install Your FastAccess Installation Wizard Software CD

Do not install the HomePortal until prompted by the Installation Wizard software.



To complete this step:

- Turn on your computer and wait until all programs have fully loaded.
- Close all applications including firewall and virus detection packages.
- Insert your CD into the CD-ROM drive.
- Follow the on-screen instructions. When prompted for equipment type Select **2Wire**.

Step 8

Install The HomePortal Setup Wizard CD On Your Additional Computers

- After installing your network adapter, you must configure each additional computer to communicate with your HomeNetwork.
 - Insert the HomePortal Setup Wizard CD in the CD-ROM drive.
 - Wait a full minute for the CD to start up.
 - Click the **Complete Installation** icon.
 - Follow the on-screen instructions. **Note:** If you have installed a computer using the wireless option, the Setup Wizard will detect the properly installed 2Wire PC Card and prompt you to enter additional information to complete the wireless setup.
 - If prompted for the key code, enter **5252-2524-6266-22AS-B2DC**
 - If prompted to enter your username, enter your Bellsouth.net username using this format: **username@bellsouth.net**
 - After a reboot, if you are prompted for a Network Password it is recommended that you leave the password blank and click **OK**.
- This computer is now connected to your home network. Please repeat steps 6, 7 and 8 for each additional computer you would like to connect to your home network.**

Note to Customers with Monitored Alarms or Emergency Response Systems: Refer to the FastAccess Wireless HomeNetworking Installation Guide for important information.

Click the "2" icon on your computer monitor for information on Sharing Files or Printers, Viewing Home Network Information or Online Help. Bellsouth HomeNetworking specialists do not support file and print sharing between Macintosh and IBM compatible computers.

>> Step 4 Connect Your First Computer To The HomePortal

Connecting Computer with Ethernet Connection

This connection type requires an available Ethernet Port. If you do not have an available Ethernet Port you can purchase an Ethernet Adapter (not provided in this kit) from any retail computer store.

- Please make sure your computer is turned off.
- Connect the provided AC power adapter (black) from the HomePortal's POWER port to an electrical outlet.
- Before proceeding to the next step, make sure the power light on the HomePortal is solid green.

- Connect the provided Ethernet cable (dark gray) from the HomePortal's LOCAL ETHERNET port to your computer's Ethernet port.
- Connect the provided telephone cable (light gray) from the HomePortal's PHONE LINE port to a telephone jack.
- If you are using the same telephone jack for your HomePortal and telephone follow the instructions below:

- Insert the Y-adapter into the telephone jack.
- Connect the phone cable from the Y-Adapter to the HomePortal's PHONE LINE Port.
- Connect the DSL Phone Line filter from the Y-Adapter to telephone cable and connect the telephone cable to the telephone.
- See the diagram to the right.
- Power computer on and wait for all programs to fully load.
- Compare HomePortal lights to status indicator photo in the right corner.

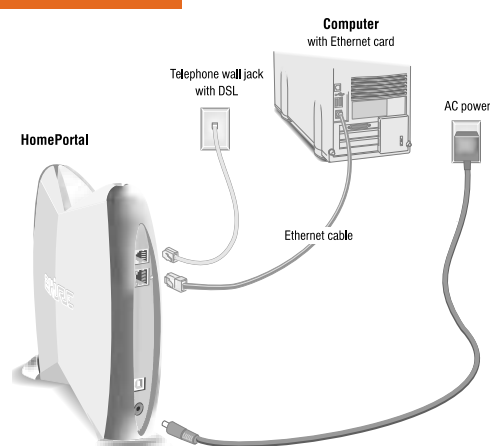

Using The Same Telephone Jack For Your HomePortal And Telephone

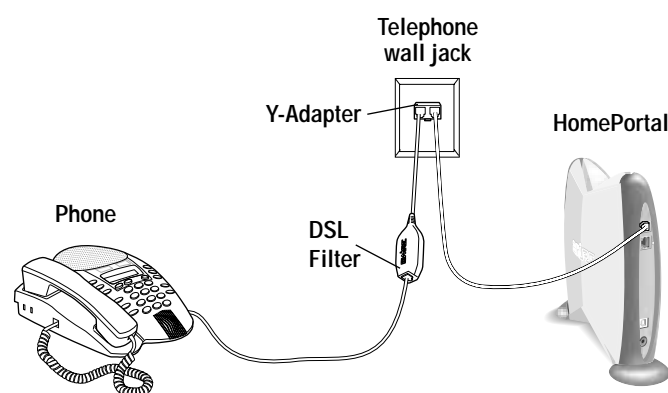

HomePortal Status Indicator
After you have completed **Step 4** and waited up to five minutes, the lights on the HomePortal should be as follows:

If the HomePortal lights are different, refer to the **Troubleshooting** section in the FastAccess DSL Wireless HomeNetworking Guide.

Refer to the BellSouth FastAccess Wireless HomeNetworking Installation Guide for USB connection instructions and other computer configurations.

>> Step 5

Your First Computer – Install the HomePortal Set Up Wizard CD

- Place the HomePortal Setup Wizard CD in CD-ROM drive.
- Wait a full minute for the CD to start up.
- Click on the "Complete Installation" icon.
- Follow the on-screen instructions.
- After the reboot, if you are prompted for a Windows Network Login, it is recommended that you leave the password blank and click **OK**.
- When prompted for the key code, enter **525Z-25Z4-6266-22AS-B2DC**
- When prompted to enter your username, enter your BellSouth.net username using this format: **username@bellsouth.net**
- Continue to follow the on-screen instructions until installation is complete.
- Compare lights on HomePortal to the status indicator photo in right corner.
- Installation is now complete on this computer. Verify that all three HomePortal lights are solid green before proceeding to the next step.

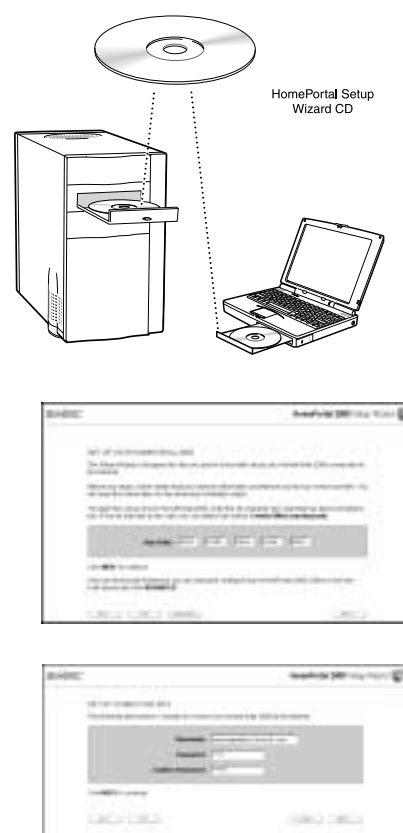

HomePortal Status Indicator
After you have completed **Step 5** and waited up to five minutes, the lights on the HomePortal should be as follows:

If the HomePortal lights are different, refer to the **Troubleshooting** section in the FastAccess DSL Wireless HomeNetworking Guide.

>> Step 6

Connecting Additional Computers To Your Network

Now that your first computer is connected to the HomePortal and your Internet connection has been established, it is time to connect your other computers to the network. There are a variety of ways to connect additional computers to your network. Computers located in different rooms can be connected using wireless or HomePNA networking. Computers connected with HomePNA use existing telephone wiring to access the Internet and other computers on the network.

Select **ONE** of the following choices for each additional computer.

Choice A Connecting computer via HomePNA using a PC Port HomePNA adapter

The PC Port can only be used with computers running Windows XP, 2000, ME, 98 Second Edition, and Macintosh 8.6 to 9.2.

- Power off your computer.
- Connect one end of the provided telephone cable to the PC Port and connect the other end of the telephone cable to any available telephone wall jack. Connect the phone cable directly to the telephone wall jack – do not use a filter.
- Insert the PC Port (USB HomePNA) Adapter into any open USB port on your computer.
- Power on your computer. Your computer will automatically recognize the adapter.
- When the "Add New Hardware Wizard" appears click **Next**.
- When prompted for drivers, insert the HomePortal Setup Wizard CD.
- Follow on-screen instructions. Select **Search CD-ROM for drivers**.
- If you receive a message indicating that "Digital Signature Not Found," click **Yes**.
- When the driver installation is complete, remove the HomePortal Setup Wizard CD.

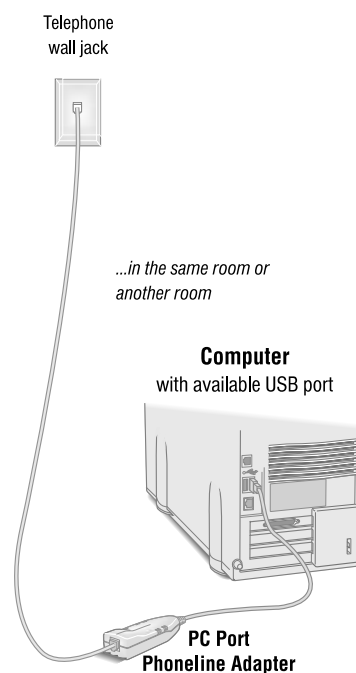

After you have completed the PC Port Adapter installation and waited up to five minutes, the Network and Power lights should be blinking or solid Green.

Choice B Connecting computer via HomePNA using a PCI HomePNA adapter

The PCI HomePNA adapter can only be used with computers running Windows XP, 2000, ME, 98 Second Edition, 95 and NT.

- Power off your computer and unplug your computer's power cord.
- Remove your computer's outside cover.
- Insert the adapter into a PCI slot. PCI slots are easily identified by their beige color, and by the fact that network cards fit snugly into it. Make sure that your card is inserted all the way into the PC slot.
- Once your PCI HomePNA adapter is firmly in place, secure its fastening tab to your computer's chassis with a mounting screw.
- Replace your computer's cover and reconnect your computer's power.
- Connect one end of the provided telephone cable to either of the adapter ports and the other end of the telephone cable to any available wall jack.
- Power on your computer. Your computer should automatically recognize the adapter.
- When the "Add New Hardware Wizard" appears click **Next**.
- When prompted for drivers, insert the HomePortal Setup Wizard CD.
- Follow the on-screen instructions. Select **Search CD-ROM for drivers**.
- If you receive a message indicating "Digital Signature Not Found," click **Yes**.
- When the driver installation is complete, remove the HomePortal Setup Wizard CD.

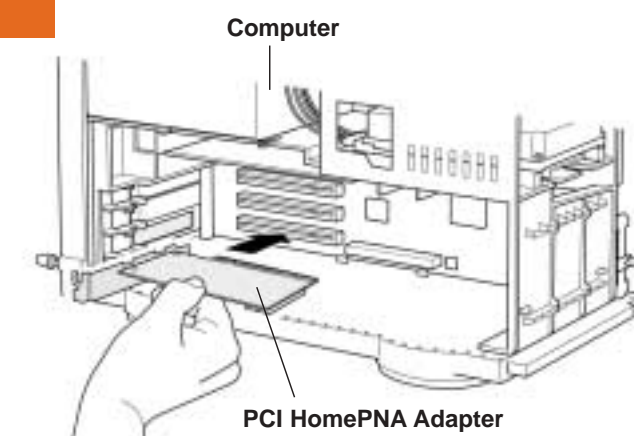

After you have completed PCI Adapter installation and waited up to five minutes, the PCI and Link/Act light should be blinking or Solid Green.

Choice C Connecting Computer using wireless

The Wireless PC Card can be used with computers running Windows XP, 2000, ME, 98 Second Edition and 98.

BellSouth recommends that you complete your wireless adapter installation in the same room as your HomePortal to receive the best signal strength and to have easy access to the numbers on the bottom of the HomePortal that will be required for installation.

- Power off your computer.
- Insert the 2Wire Wireless PC Card into the PC card slot.
- Power on your computer. Your computer will automatically recognize the card.
- When the "Add New Hardware Wizard" appears, click **Next**.
- When prompted for the drivers, insert the HomePortal Setup Wizard CD into the CD-ROM drive.
- Follow on-screen instructions. Select **Search CD-ROM for drivers**.
- If you receive a message indicating "Digital Signature Not Found," click **Yes**.
- When the driver installation is complete, remove the HomePortal Setup Wizard CD.

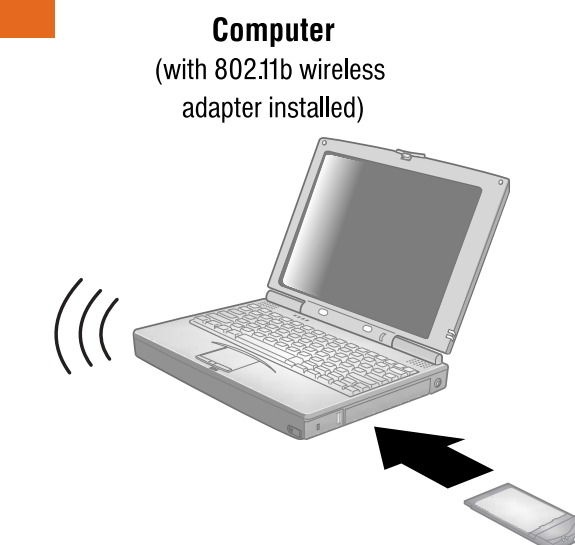

After you have completed wireless adapter installation and waited up to five minutes, one light should be solid Green and the other should be blinking Green.

Refer to the BellSouth FastAccess Wireless HomeNetworking Installation Guide for instructions on connecting other computers to the HomePortal.

If you need additional adapters, visit fastaccess.com and choose "For Home" and then choose "Your FastAccess DSL Account".